

PRODUCT: RG - ^{TD}XX - ^AXX - AX10

ORDER DESC: OBXX - OAXX - AX10XXXX^D ^{LC}

RG800 SERIES - MILD STEEL GRAVITY ROLLER WITH CROSS DRILLED AXLE

DIMENSION	MEASUREMENT
TD	
A	
OB	
OA	
EXTN	
D	
LC	

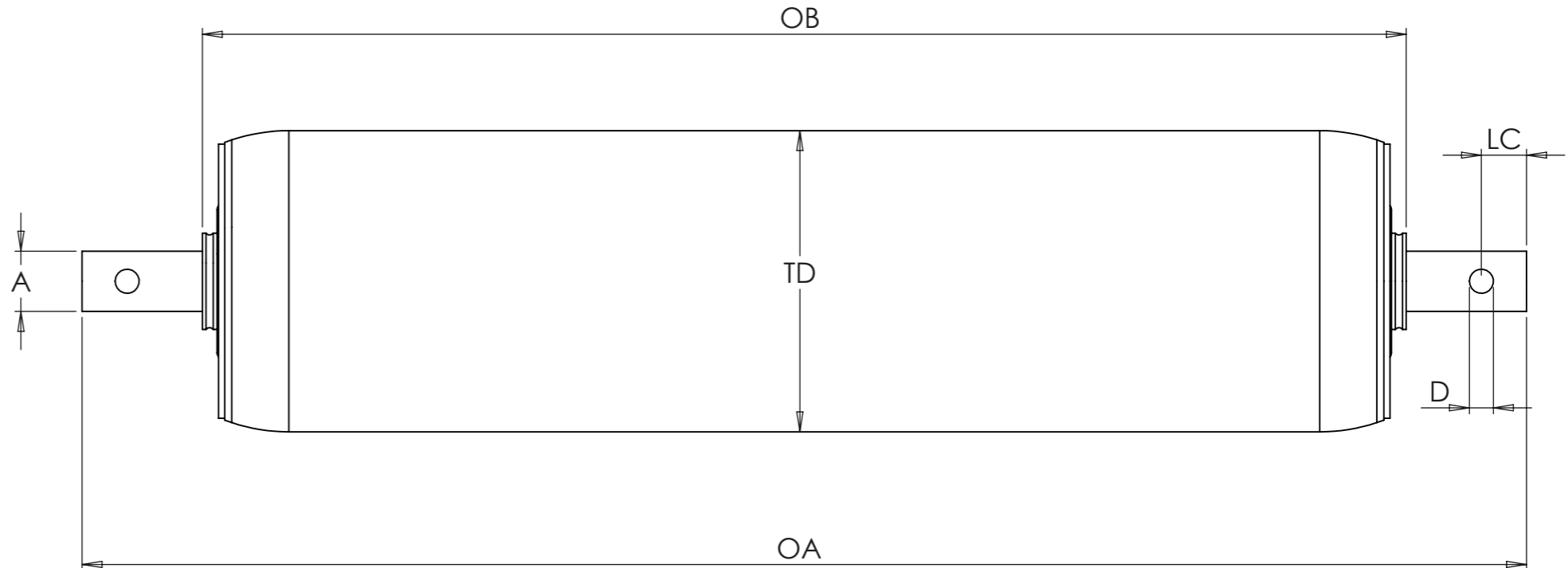

PART CODE BREAKDOWN

TD = TUBE DIA
 A = AXLE DIA
 OB = OVER BEARING
 OA = OVER AXLE
 AX10 = CROSS DRILLED AXLE
 D = HOLE DIAMETER
 LC = HOLE LOCATION

BELOW ARE TUBE DIAMETER OPTIONS, PLEASE SELECT AXLE FROM THE SAME ROW

TD	TUBE DIAMETER & THICKNESS	ROUND AXLE (A)				HEX AXLE (A)	
		∅	∅	∅	∅	HEX	HEX
30	∅30 X 1.5	8	10	-	-	-	-
40	∅40 X 1.5	8	10	11	12		11 HEX
50	∅50 X 1.5	8	10	11	12	8 HEX	11 HEX
50MD	∅50.8 X 2	8	10	11	12	8 HEX	11 HEX
60	∅60 X 2	-	10	11	12		11 HEX

GENERATE ORDER CODE BELOW

QTY:

RG-^{TD}____-^A____-AX10

OB____-OA____-AX10XXXX^D ^{LC}

UNIT 3, ALBION WORKS
 MOOR STREET,
 BRIERLEY HILL,
 WEST MIDS,
 ENGLAND,
 DY5 3SZ



COPYRIGHT RESERVED		REVISION: 1
TITLE:		RG800 SERIES
DWG NO.	RG-ORDER-AX10	A3
SCALE:1:2	SHEET 1 OF 1	

UNLESS OTHERWISE SPECIFIED: DIMENSIONS ARE IN MILLIMETERS			DEBURR AND BREAK SHARP EDGES	DO NOT SCALE DRAWING
NAME	REVISION	DATE	FINISH: BZP	
DRAWN	K JEAVONS	1	MATERIAL: MILD STEEL	
WEIGHT:			SCALE:1:2	